

GPS Insight and Coast have partnered to help fleets streamline their operations through seamless data integration. By connecting the two platforms, Coast can use GPS Insight location data to validate fuel transactions automatically. If a vehicle is not within a set distance of the fueling location at the time of purchase, the transaction can be flagged for review.

This guide walks you through the process of preparing your GPS Insight account, generating the required Coast API key, and completing the integration.

1. Prepare Your GPS Insight Account

Before connecting to Coast, you will need a dedicated GPS Insight user for the integration.

1. Create a dedicated user in the GPS Insight Portal (**Example username:** `simplytransit.coast`).
2. Ensure the dedicated user has restricted vehicle access and permissions for API use only (this increases security and ensures the integration only has access to the vehicles you choose).

Once the user is created, you're ready to move into the Coast portal.

2. Generate a Coast API Key

1. Log in to your Coast account and navigate to "Integrations."
2. Select **Apps**.
3. On the GPS Insight tile, click **Open**.

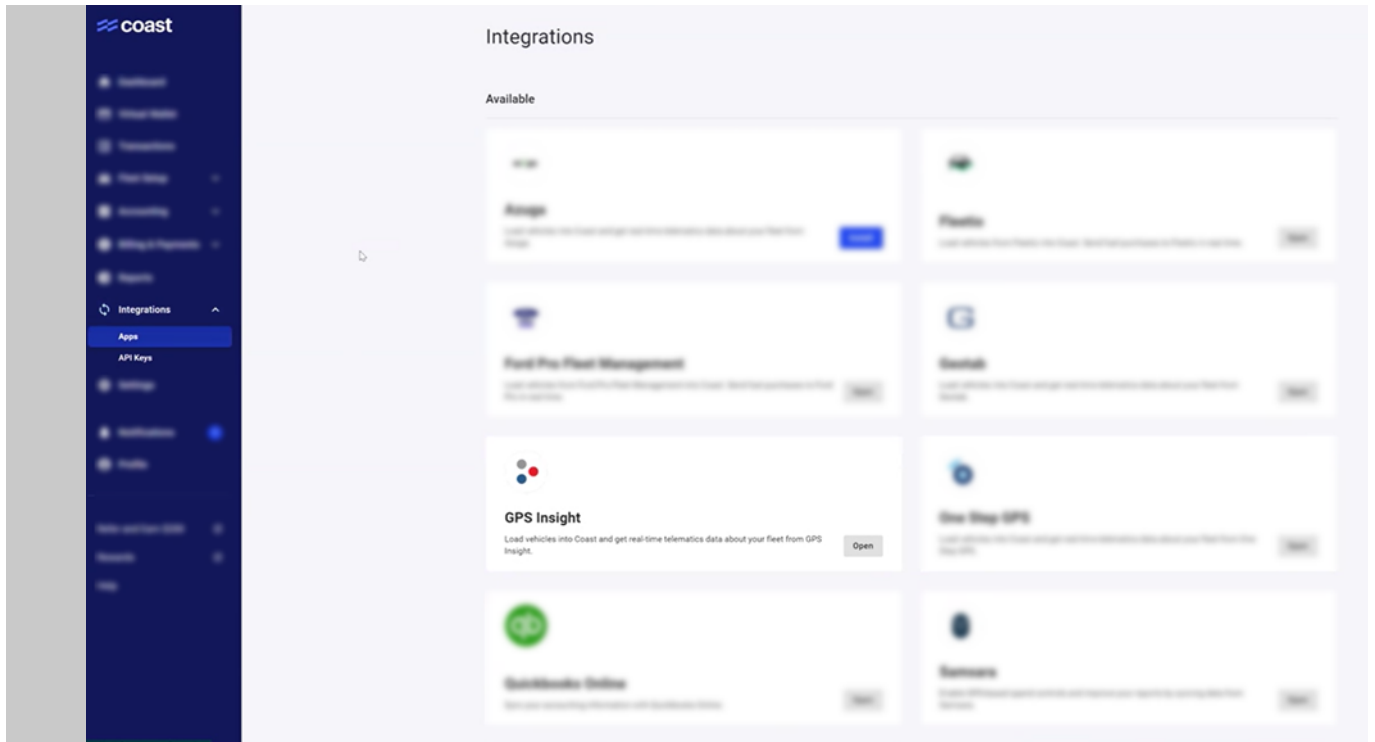

4. Click **API Keys** in the Need an API Key? box.

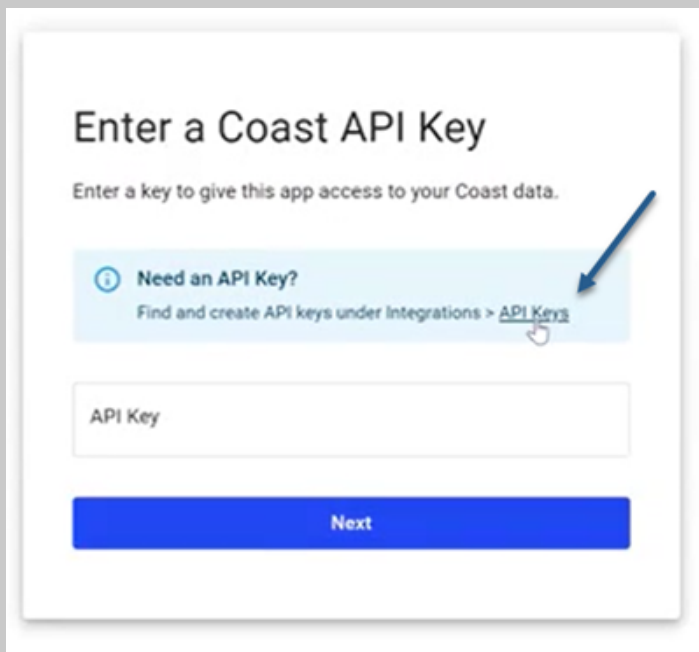

5. Click **New API Key** at the top-right corner of the screen.

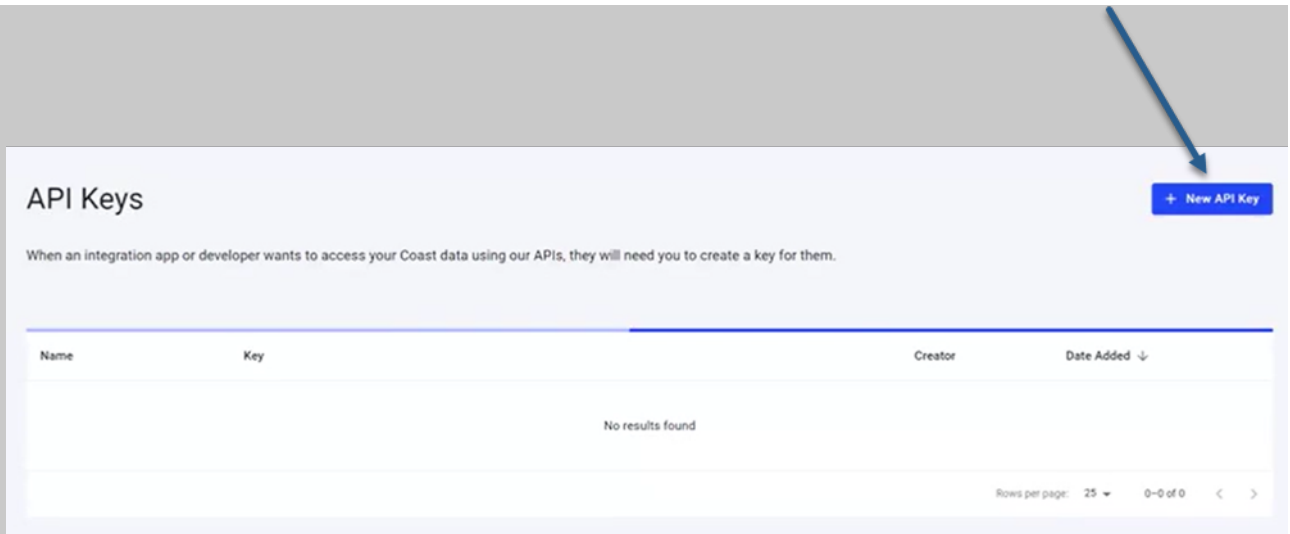

6. Name the key "GPS Insight Key" then click **Next**.

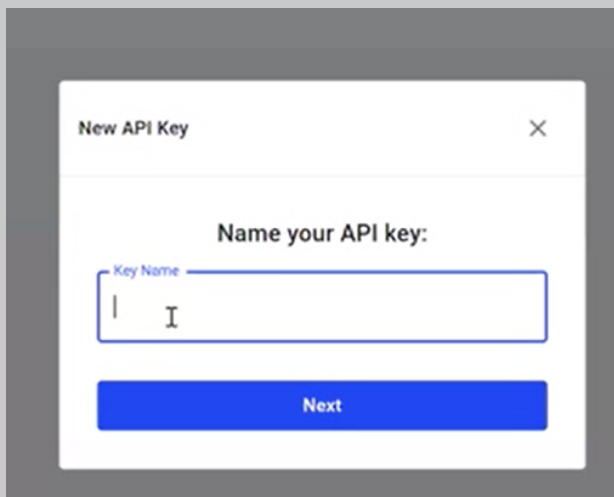

7. Coast will generate an API Key. Click **Copy & Close** to save it.

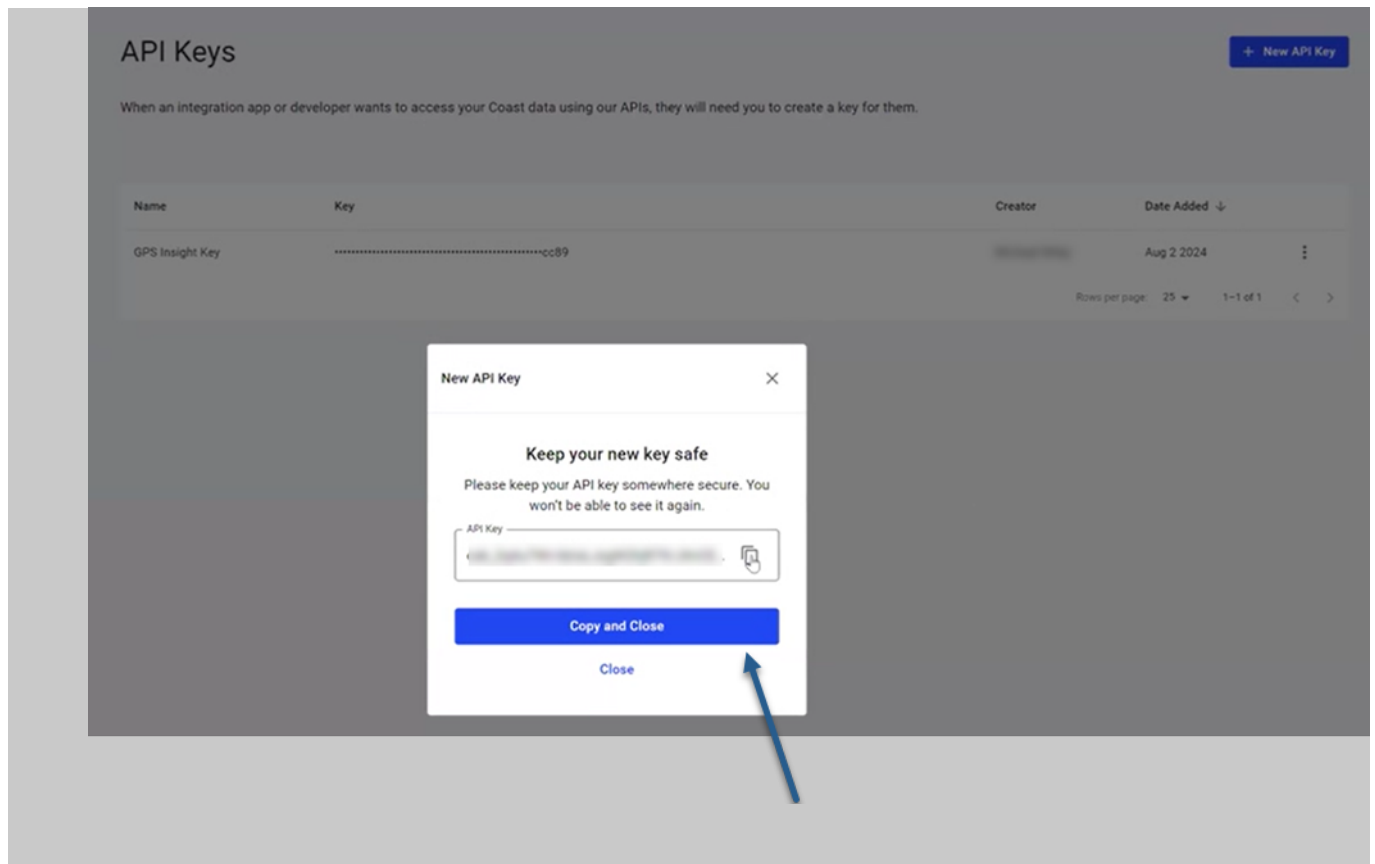

3. Add the API Key to the GPS Insight Integration

1. Return to the previous **Coast API Key** tab.
2. Paste the API key you copied.
3. Click **Next**.

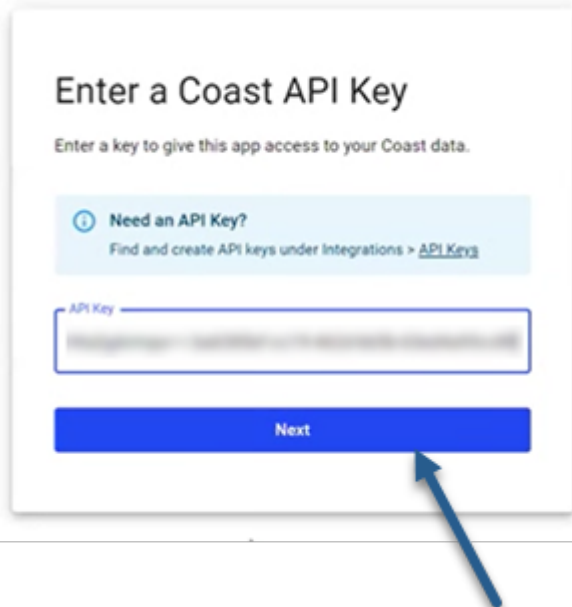

4. Connect Your GPS Insight Account

1. A “Connect to GPS Insight Account” prompt will appear; click **Connect**.

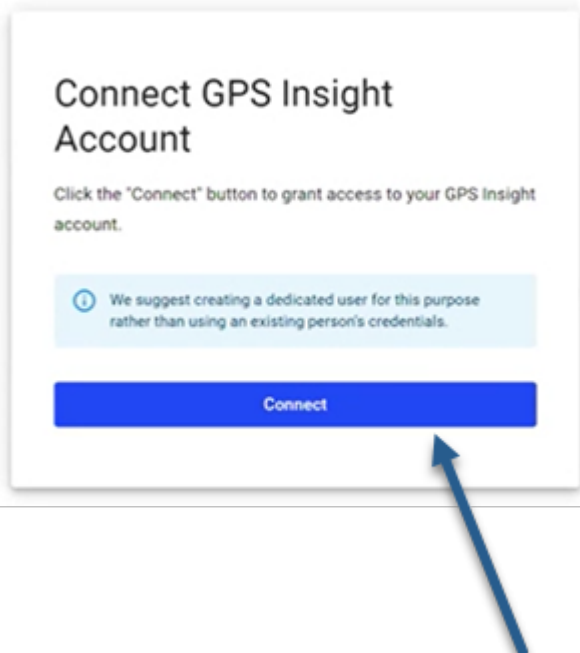

2. Click **Continue** when prompted.

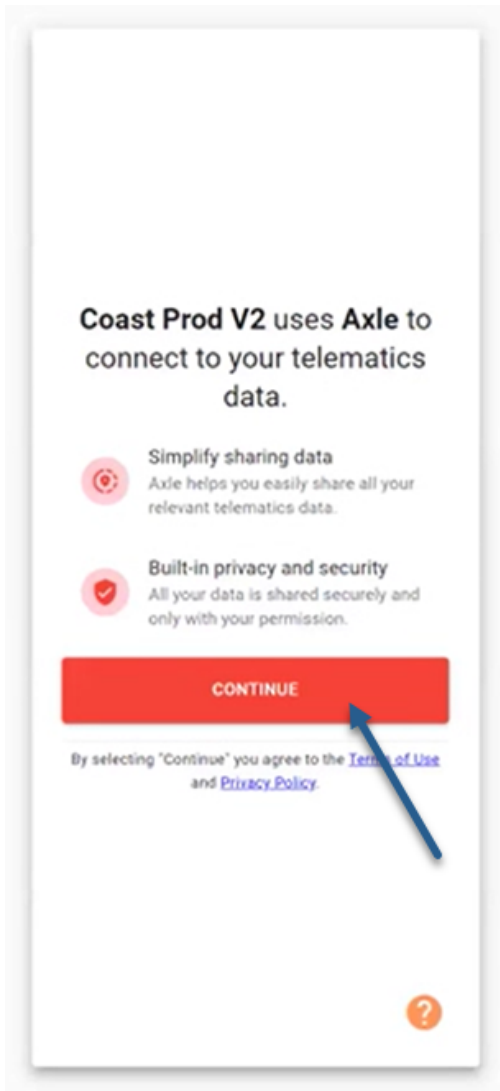

3. Enter the **GPS Insight username and password** for the dedicated Coast integration user you created earlier.
4. Click **Login** to complete authentication.

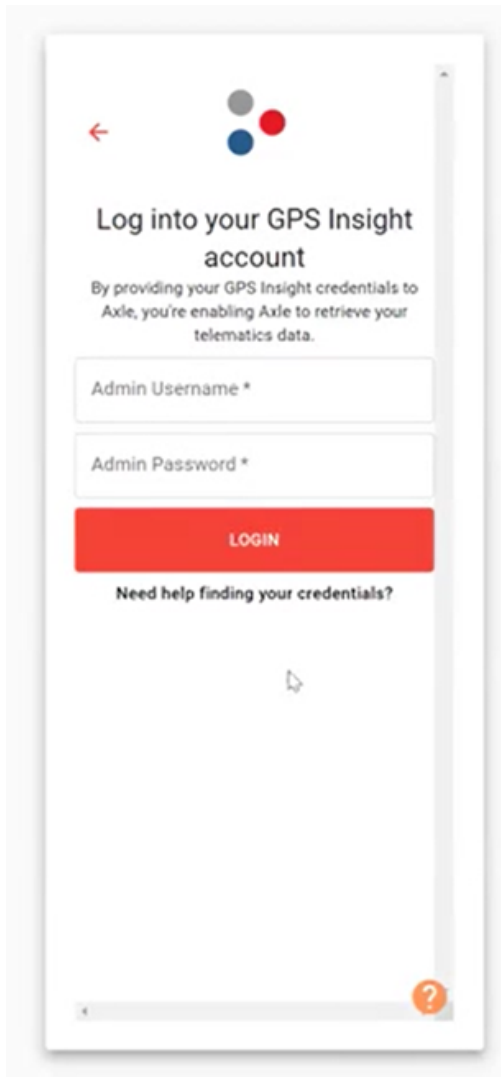

5. Finalize the Integration

1. Click **Sync Now** to trigger an immediate sync.

GPS Insight Dashboard

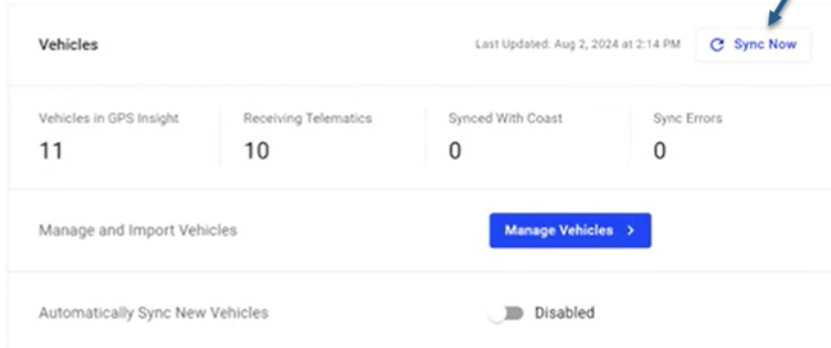

Vehicles Last Updated: Aug 2, 2024 at 2:14 PM [Sync Now](#)

| Vehicles in GPS Insight | Receiving Telematics | Synced With Coast | Sync Errors |
|-------------------------|----------------------|-------------------|-------------|
| 11 | 10 | 0 | 0 |

Manage and Import Vehicles [Manage Vehicles >](#)

Automatically Sync New Vehicles Disabled

Coast
API Key
.....cc89

[Update](#)

GPS Insight Connection

[Update](#)

[Disconnect](#)

Receive Telematics Data
We will fetch data every minute for all devices found in GPS Insight. We'll update your vehicles in Coast as long as they have a matching License Plate or VIN.

Import Vehicles
If you have vehicles in GPS Insight that aren't already in Coast, you can import them. Vehicles will only be imported if they have a unique License Plate.

Updates in GPS Insight will be synced to Coast automatically. This happens every day at 5AM, 11AM, and 5PM EST.

2. Enable **Automatically Sync New Vehicles** to ensure new GPS Insight vehicles are added automatically.

GPS Insight Dashboard

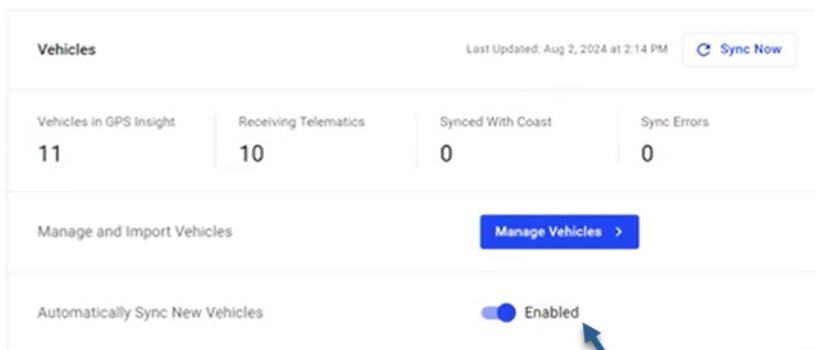

Vehicles Last Updated: Aug 2, 2024 at 2:14 PM [Sync Now](#)

| Vehicles in GPS Insight | Receiving Telematics | Synced With Coast | Sync Errors |
|-------------------------|----------------------|-------------------|-------------|
| 11 | 10 | 0 | 0 |

Manage and Import Vehicles [Manage Vehicles >](#)

Automatically Sync New Vehicles Enabled

Coast
API Key
.....cc89

[Update](#)

GPS Insight Connection

[Update](#)

[Disconnect](#)

Receive Telematics Data
We will fetch data every minute for all devices found in GPS Insight. We'll update your vehicles in Coast as long as they have a matching License Plate or VIN.

Import Vehicles
If you have vehicles in GPS Insight that aren't already in Coast, you can import them. Vehicles will only be imported if they have a unique License Plate.

Updates in GPS Insight will be synced to Coast automatically. This happens every day at 5AM, 11AM, and 5PM EST.

Your Integration Is Complete!

Coast will now use GPS Insight vehicle location data to validate fueling transactions in real-time. Any transaction occurring outside the approved proximity to a fuel pump can be automatically flagged for review—enhancing both security and control across your fleet.